

ELECTRIC COMB BINDING MACHINE

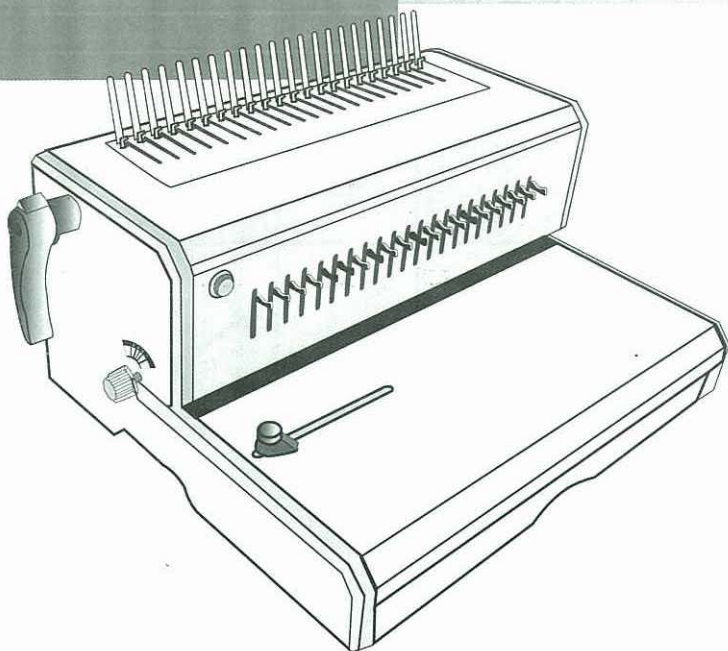

Instruction Book

APPELLATION

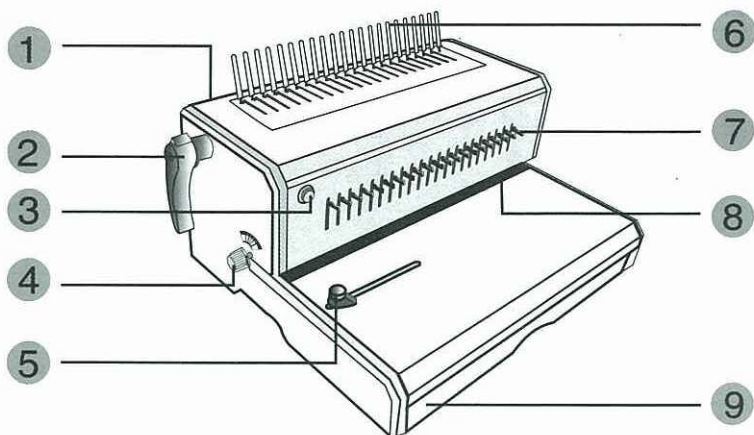

① Power Switch

② Plastic Ring Pulling Knob

③ Punching handle

④ Depth Margin

⑤ Paper Location

⑥ Comb

⑦ Punching Selector

⑧ Paper entrance

⑨ Waster paper box

IMPORTANT SAFETY INSTRUCTIONS-Read Before Using!

- 1、 It is suggested that try to bind document and avoid binding material like PP、PVC to maintain long term usage of machine.
- 2、 To make a book binded perfectly . pls make sure paper cover and back cover should be punched together with documents to avoid offsetting.
- 3、 The documents should be put on the base plate flatly while punching.
- 4、 Clear the waste paper and other things from the base plate before punching.
- 5、 Make sure that punch below 15 sheets each time.
- 6、 Pls power off when finished using the machine.
- 7、 Pls use this machine as per manual and all the advice.

OPERATION

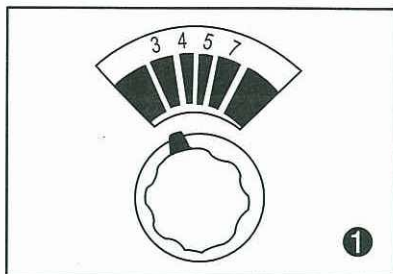

- 1、 Turn on . select the position of paper location and depth margin as per the thickness of documents and size of plastic ring . then insert the documents

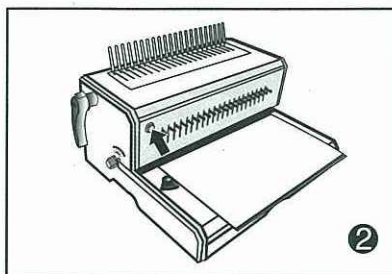

- 2、 Insert documents . and press the punching button

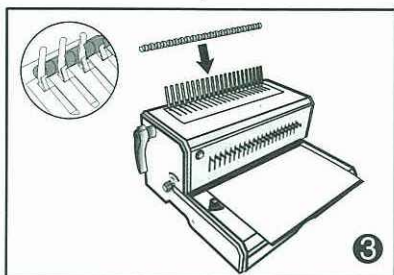

- 3、 Put the plastic ring on the comb . and make sure its mouth up

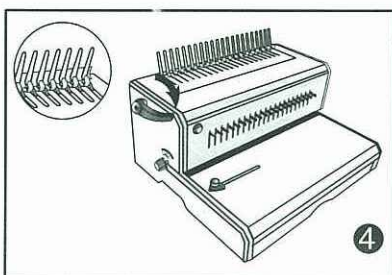

- 4、 Move the plastic ring pulling handle ahead . and open the plastic ring .

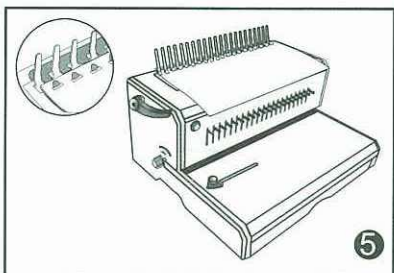

- 5、 Put the punched documents on the plastic ring .

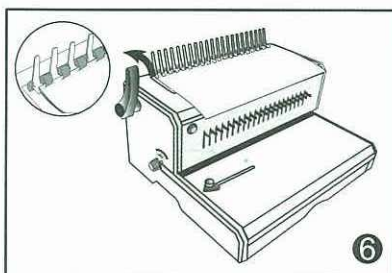

- 6、 Move back the plastic ring pulling handle .close the plastic ring .and take out the documents. Finally turn off .

KEEP THE MACHINE CLEAN

When cleaning the cover, please clean with a damp cloth using mild soap and water solution the use of abrasives.

SPECIFICATIONS

Type	
Binding capacity	230 sheets/ 25.4mm
Paper size	Below than A4 paper
Punching capacity	15 sheets(80g paper)
Facilities	21 international standard hole
Hole spec	3.0x8.0mm
Punching form	Electric
Net weight	17 kgs
Product size	450x350x250mm

Guarantee Card

1. any quality within one year .we will be obligate to repair freely. After one year , we will charge for any repairing as per our standard.
2. we will only be obligate to repair the problems because of quality .any other reason is out of the repairing range like opening the machine privately , wrong usage or installation.
3. free repairing must refer to this guarantee card and invoice
If the above documents are not available. The guarantee period will be started one month after the ex-work date.
4. before use , please read the manual carefully. Any confusion please question to sales department.

Product name _____

Product model _____

Ex-work date _____

Purchase date _____

Purchase price _____

Accessory _____

Fill in the form, please

Usage name _____ (Mr/Miss)

Address and Postcode _____

Telephone _____

Email _____